

Deliverable D

Group 12 (Samuel, Tofehinti, Tofarati, Ojonuma, Muhammad)

Conceptual Design

Jig

- The whole system will be able to accommodate different jig sizes and patterns, from 4.5"x4.5" to 5.5"x5.5", as the mechanisms that connect the jigs to the sliding mechanism will be the same regardless of the jig size.
- Each jig will have extrusions similar to tubes coming out of each drill hole that are to make the drill stable while the hole is being drilled.

Clamp

- One side of the clamp will always be stationary and one side can be tightened and loosened by turning a screw, similar to a C-Clamp.
- The clamps will be padded on the sides that will touch the door so that the door does not get damaged.
- The clamps will have rounded edges so that the door does not get damaged.

Lock-in Slide

- The slide has a screw that, when you have the clamps in place, can be screwed in to lock the clamps in place.
- Using the slide, you can unscrew the jig that is in it and slide a new jig template into it to use.

Front view

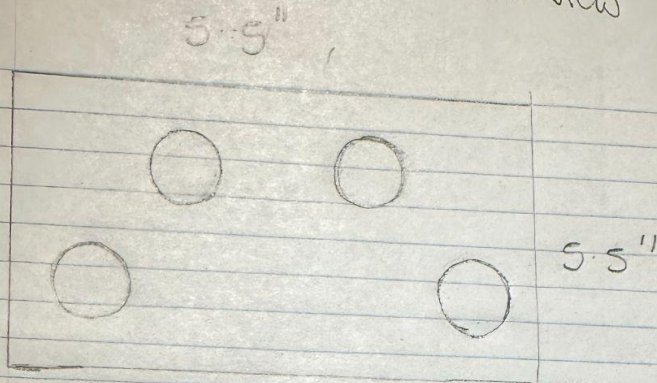

SIDE VIEW

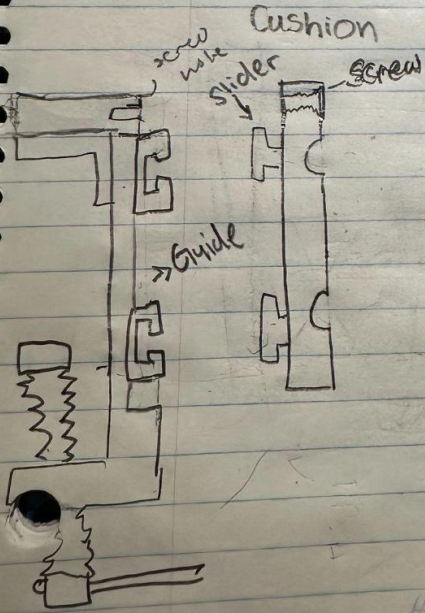
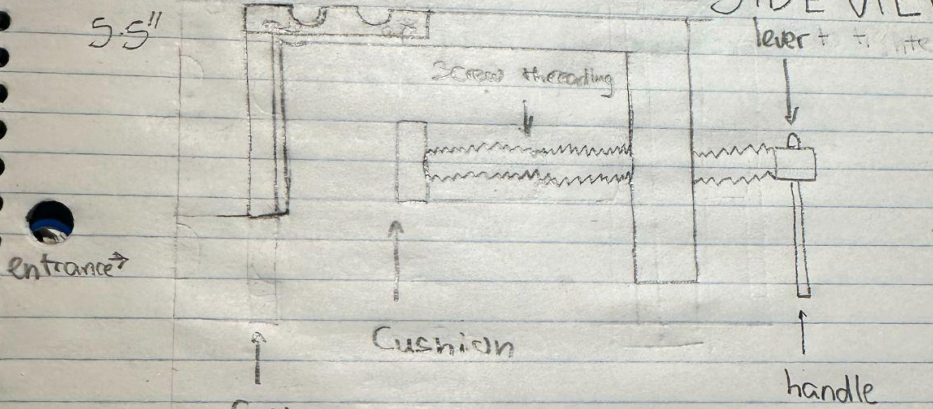

JIG Template

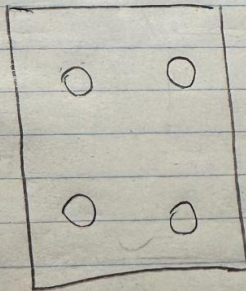

The LOCKSLIDE

Hiboy